

Features

- Infinite speed control allows for site specific optimization
- Integrates with all RTU's capable of sending a 4-20mA signal
- Automatically switches from manual to auto control when analog signal is present
- Plug and Play technology allows simple integration when upgrading existing non analog packages
- Robust construction ensures long service life
- Dynamic current control
- Optimized I/O filtering for EMC conformance

Technical Data

- **Auxiliary Power Supply:**
24V DC (28.5 MAX)
- **Analog Input:**
4-20mA
- **Power consumption:**
Standby - <0.02A
- **Operating Temperature:**
-50 to 50 Degrees C
- **Classification:**
CSA CLASS1 DIV 2*

*Requires Nema type 3R (or equivalent) enclosure to maintain this rating.

[TOP VIEW]

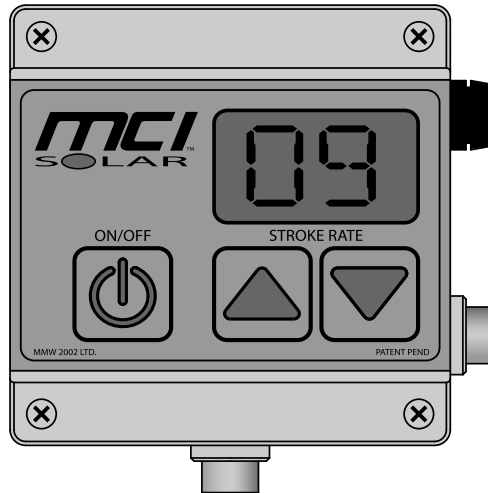

AUX. POWER SUPPLY
RECEPTACLE - 24V DC

ANALOG INPUT RECEPTACLE
4-20mA

[FRONT VIEW]

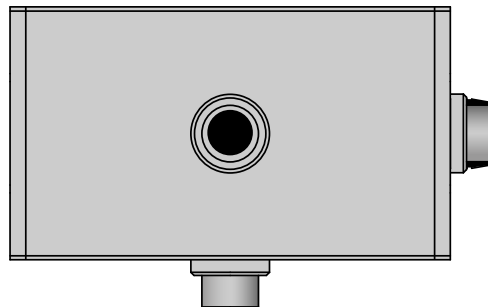

MOTOR POWER
SUPPLY RECEPTACLE

4-20mA Wiring Diagram [With Supplied Interface Cable]

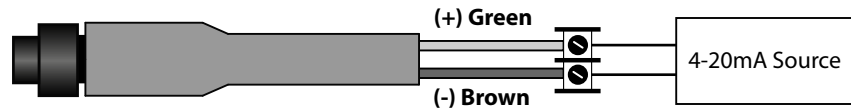

Description

The Z-CM-AI analog capable controller is designed for operation with MCI SOLUTIONS electric chemical injection series pumps.

The motor controller is capable of receiving a 4-20mA analog signal for RTU interface to SCADA. It will control all pump operations remotely - speed control and remote on/off.

A 4.5mA signal remotely turns the pump off. Full stroke range is achieved through a series of setpoints from 5-20 mA. This controller automatically switches to manual mode if the analog signal is not present. This ensures seamless integration in all field applications.

